

# Accessories

## Accessories at a glance

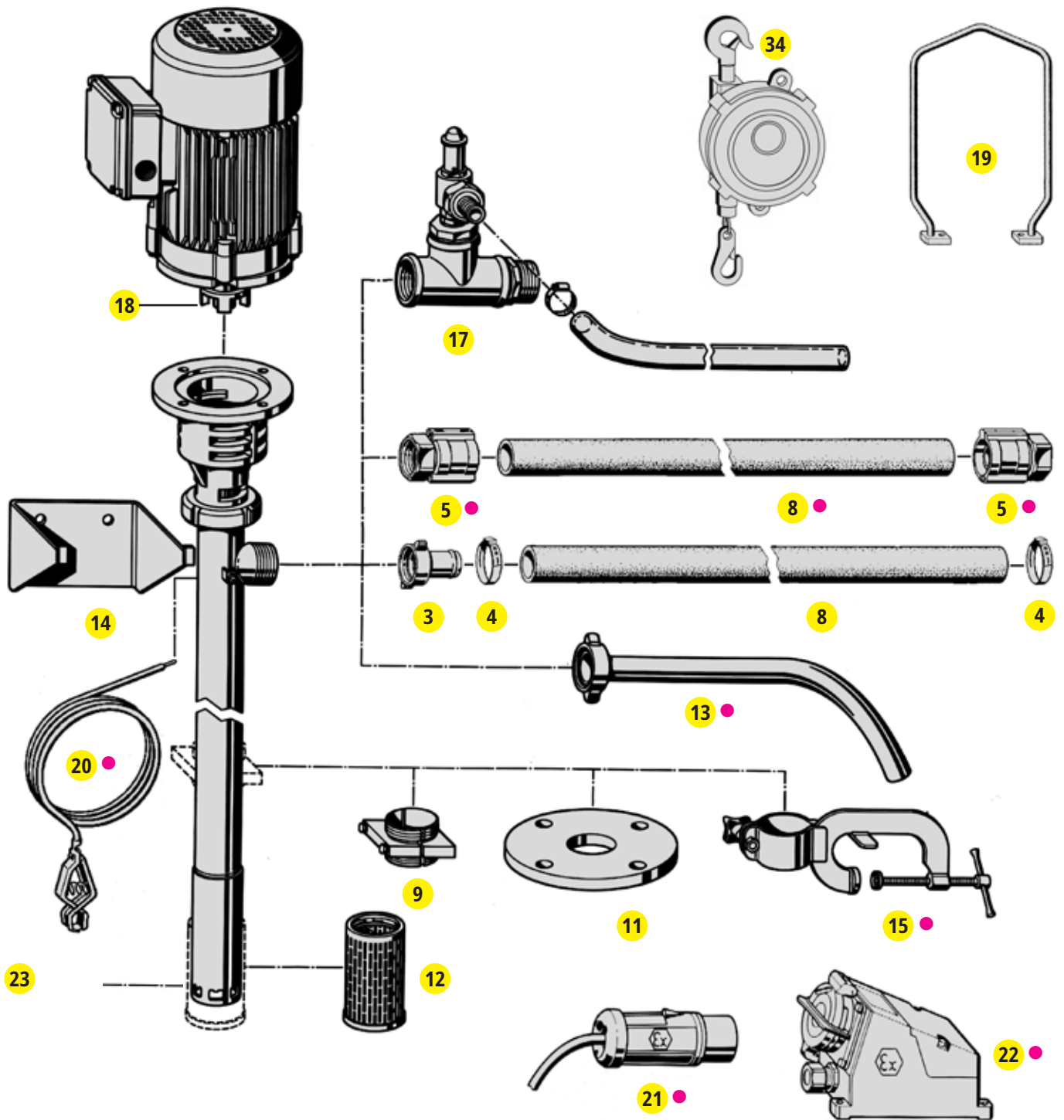

**3** Hose connection

**4** Hose clips

**5** ● Hose connector

**8** ● Hose

**9** Drum adapter

**11** Installation flange

**12** Foot strainer

**13** ● Discharge spout

**14** Wall bracket

**15** ● Clamping device

**17** Bypass valve

**18** Coupling part, motor side

**19** Lifting device

**20** ● Equipotential bonding cable

**21** ● Ex-plug

**22** ● Ex-socket

**23** Protection device for drum inliner







**34** Hoist

● Suitable for transferring combustible and easy inflammable liquids (e.g. ethanol, petrol) or in explosive hazard area.

Specification	Order-No.	Product detail
<p><b>3 Hose connection</b></p> <p>For connecting the hoses to the pump tube B70V. Connection thread: G 1 1/2</p> <p>Material:                      Nominal diameter:</p> <p>Stainless steel                DN 25 (1")</p> <p>Stainless steel                DN 32 (1 1/4")</p> <p>Stainless steel                DN 38 (1 1/2")</p> <p>Aluminium                     DN 32 (1 1/4")</p>	<p><b>0204-416</b></p> <p><b>0204-417</b></p> <p><b>0204-418</b></p> <p><b>0204-420</b></p>	
<p><b>9 Drum adapter St 37</b></p> <p>Separable drum adapter for pump tubes with enlarged pump foot. For fixing the pump in the drum opening. Prevents the eccentric screw pump falling over in the empty drum. Thread G 2 and M 64 x 4. for pump tube B70V ø 52 mm</p>	<p><b>0204-169</b></p>	
<p><b>9 Drum adapter PP</b></p> <p>For fixing the pump in the drum opening. Prevents the eccentric screw pump falling over in the empty drum. for pump tube B70V ø 52 mm</p>	<p><b>0208-056</b></p>	
<p><b>11 Installation flange</b></p> <p>According to DIN 2576 DN 80. PN 10 For fixing the pump B70V to a companion flange. The flange is welded onto the pump tube. in stainless steel (1.4571)</p>	<p><b>0170-310</b></p>	
<p><b>12 Foot strainer</b></p> <p>Available in stainless steel, for mounting on the pump foot. Keeps impurities away from the rotating parts. in stainless steel (1.4571)</p>	<p><b>0204-802</b> ●</p>	
<p><b>13 Discharge spout</b></p> <p>Serving to transfer and fill liquids directly into other vessels. They are available in aluminium and stainless steel and are threaded onto the pump outlet connection.</p> <p>Material:                      Nominal diameter:                      Wing nut:</p> <p>Alu                              DN 25 (1")                              G 1 1/2</p> <p>SS                                DN 25 (1")                              G 1 1/2</p>	<p><b>0204-374</b></p> <p><b>0204-226</b> ●</p>	
<p><b>14 Wall bracket</b></p> <p>For storage of drum pumps.</p> <p>B70V</p> <p>B70V-SR</p>	<p><b>0204-309</b></p> <p><b>0204-307</b></p>	
<p><b>15 Clamping device</b></p> <p>To fasten the eccentric screw pump B70V in open-topped and thick-walled drums and containers. in stainless steel</p>	<p><b>0205-052</b> ●</p>	
<p><b>17 Bypass valve</b></p> <p>When using a closing valve (nozzle, stop valve etc.) the application of a bypass valve is recommended. (Opening pressure: brass 2.5 bar, stainless steel 5 bar).</p> <p>Connection thread:        G 1 1/2</p> <p>Material                        for pump tube</p> <p>Brass                            B70V</p> <p>Stainless steel 1.4571        B70V</p> <p>Brass                            HD-E</p>	<p><b>0172-640</b></p> <p><b>0170-274</b></p> <p><b>0155-600</b></p>	

● Suitable for transferring combustible and easy inflammable liquids (e.g. ethanol, petrol) or in explosive hazard area.

# Accessories

Product detail	Specification	Order-No.																																								
	<p><b>18 Coupling part, motor side</b></p> <p>When sourcing your own motor please order the correct coupling to suit the relative shaft diameter.</p> <table border="0"> <tr> <td>Shaft diameter:</td> <td>ø 14 mm</td> <td>for B70V 12.1 up to 75.1</td> <td><b>0302-028</b></td> </tr> <tr> <td></td> <td>ø 19 mm</td> <td>for B70V 12.1 up to 75.1</td> <td><b>0302-027</b></td> </tr> <tr> <td></td> <td>ø 24 mm</td> <td>for B70V 12.1 up to 75.1</td> <td><b>0302-026</b></td> </tr> <tr> <td></td> <td>ø 28 mm</td> <td>for B70V 12.1 up to 75.1</td> <td><b>0302-029</b></td> </tr> <tr> <td></td> <td colspan="2">(only in combination with intermediate flange)</td> <td></td> </tr> <tr> <td>Intermediate flange for shaft diameter:</td> <td>ø 28 mm</td> <td>for B70V 12.1 up to 75.1</td> <td><b>0172-782</b></td> </tr> <tr> <td></td> <td>ø 24 mm</td> <td>for B70V 120.1</td> <td><b>0302-363</b></td> </tr> <tr> <td></td> <td>ø 25 mm</td> <td>for B70V 120.1</td> <td><b>0302-365</b></td> </tr> <tr> <td></td> <td>ø 28 mm</td> <td>for B70V 120.1</td> <td><b>0302-364</b></td> </tr> <tr> <td></td> <td>ø 30 mm</td> <td>for B70V 120.1</td> <td><b>0302-214</b></td> </tr> </table>	Shaft diameter:	ø 14 mm	for B70V 12.1 up to 75.1	<b>0302-028</b>		ø 19 mm	for B70V 12.1 up to 75.1	<b>0302-027</b>		ø 24 mm	for B70V 12.1 up to 75.1	<b>0302-026</b>		ø 28 mm	for B70V 12.1 up to 75.1	<b>0302-029</b>		(only in combination with intermediate flange)			Intermediate flange for shaft diameter:	ø 28 mm	for B70V 12.1 up to 75.1	<b>0172-782</b>		ø 24 mm	for B70V 120.1	<b>0302-363</b>		ø 25 mm	for B70V 120.1	<b>0302-365</b>		ø 28 mm	for B70V 120.1	<b>0302-364</b>		ø 30 mm	for B70V 120.1	<b>0302-214</b>	
Shaft diameter:	ø 14 mm	for B70V 12.1 up to 75.1	<b>0302-028</b>																																							
	ø 19 mm	for B70V 12.1 up to 75.1	<b>0302-027</b>																																							
	ø 24 mm	for B70V 12.1 up to 75.1	<b>0302-026</b>																																							
	ø 28 mm	for B70V 12.1 up to 75.1	<b>0302-029</b>																																							
	(only in combination with intermediate flange)																																									
Intermediate flange for shaft diameter:	ø 28 mm	for B70V 12.1 up to 75.1	<b>0172-782</b>																																							
	ø 24 mm	for B70V 120.1	<b>0302-363</b>																																							
	ø 25 mm	for B70V 120.1	<b>0302-365</b>																																							
	ø 28 mm	for B70V 120.1	<b>0302-364</b>																																							
	ø 30 mm	for B70V 120.1	<b>0302-214</b>																																							
	<p><b>19 Lifting device</b></p> <p>To simplify the process of lifting the pump in and out of drums or containers. When using an explosion proof driving motor the Ex-protective plug is mounted onto the lifting device.</p> <p>for pump tube HD-E <b>0155-154</b>          for B70V-SR with universal motor <b>0174-607</b>          Additional price for lifting device for motor protective switch (Ex) for pump tubes B70V (Ex) <b>0172-838</b></p>																																									
	<p><b>Motor protective switch for motor B70V</b></p> <p>Explosion proof according to EEx de IIC T6 with thermal and electromagnetic trip, protection type IP 66. Suitable lifting device for the mounting (item 19).</p> <table border="0"> <tr> <td>Ex, 1.6 - 2.5 A</td> <td>for B70V (Ex)</td> <td><b>0335-414</b> ●</td> </tr> <tr> <td>Ex, 2.5 - 4.0 A</td> <td>for B70V (Ex)</td> <td><b>0335-419</b> ●</td> </tr> <tr> <td>Ex, 4.0 - 6.3 A</td> <td>for B70V (Ex)</td> <td><b>0335-420</b> ●</td> </tr> </table>	Ex, 1.6 - 2.5 A	for B70V (Ex)	<b>0335-414</b> ●	Ex, 2.5 - 4.0 A	for B70V (Ex)	<b>0335-419</b> ●	Ex, 4.0 - 6.3 A	for B70V (Ex)	<b>0335-420</b> ●																																
Ex, 1.6 - 2.5 A	for B70V (Ex)	<b>0335-414</b> ●																																								
Ex, 2.5 - 4.0 A	for B70V (Ex)	<b>0335-419</b> ●																																								
Ex, 4.0 - 6.3 A	for B70V (Ex)	<b>0335-420</b> ●																																								
	<p><b>21 Ex-plug</b></p> <p>CEE round plug in accordance with EEx de IIC T6, splash proof in compliance with IP 65.</p> <table border="0"> <tr> <td>3-pole (alternating current) CEAG</td> <td>for B70V-SR (Ex)</td> <td><b>0336-536</b> ●</td> </tr> <tr> <td>3-pole (alternating current) STAHL</td> <td>for B70V-SR (Ex)</td> <td><b>0336-540</b> ●</td> </tr> <tr> <td>5-pole (three phase current) CEAG</td> <td>for B70V (Ex)</td> <td><b>0336-537</b> ●</td> </tr> <tr> <td>5-pole (three phase current) STAHL</td> <td>for B70V (Ex)</td> <td><b>0336-541</b> ●</td> </tr> </table>	3-pole (alternating current) CEAG	for B70V-SR (Ex)	<b>0336-536</b> ●	3-pole (alternating current) STAHL	for B70V-SR (Ex)	<b>0336-540</b> ●	5-pole (three phase current) CEAG	for B70V (Ex)	<b>0336-537</b> ●	5-pole (three phase current) STAHL	for B70V (Ex)	<b>0336-541</b> ●																													
3-pole (alternating current) CEAG	for B70V-SR (Ex)	<b>0336-536</b> ●																																								
3-pole (alternating current) STAHL	for B70V-SR (Ex)	<b>0336-540</b> ●																																								
5-pole (three phase current) CEAG	for B70V (Ex)	<b>0336-537</b> ●																																								
5-pole (three phase current) STAHL	for B70V (Ex)	<b>0336-541</b> ●																																								
	<p><b>22 Ex-socket</b></p> <p>CEE-socket in accordance with EEx de IIC T6, splash proof in compliance with IP 65.</p> <table border="0"> <tr> <td>3-pole (alternating current) CEAG</td> <td>for B70V-SR (Ex)</td> <td><b>0336-531</b> ●</td> </tr> <tr> <td>3-pole (alternating current) STAHL</td> <td>for B70V-SR (Ex)</td> <td><b>0336-542</b> ●</td> </tr> <tr> <td>5-pole (three phase current) CEAG</td> <td>for B70V (Ex)</td> <td><b>0336-420</b> ●</td> </tr> <tr> <td>5-pole (three phase current) STAHL</td> <td>for B70V (Ex)</td> <td><b>0336-543</b> ●</td> </tr> </table>	3-pole (alternating current) CEAG	for B70V-SR (Ex)	<b>0336-531</b> ●	3-pole (alternating current) STAHL	for B70V-SR (Ex)	<b>0336-542</b> ●	5-pole (three phase current) CEAG	for B70V (Ex)	<b>0336-420</b> ●	5-pole (three phase current) STAHL	for B70V (Ex)	<b>0336-543</b> ●																													
3-pole (alternating current) CEAG	for B70V-SR (Ex)	<b>0336-531</b> ●																																								
3-pole (alternating current) STAHL	for B70V-SR (Ex)	<b>0336-542</b> ●																																								
5-pole (three phase current) CEAG	for B70V (Ex)	<b>0336-420</b> ●																																								
5-pole (three phase current) STAHL	for B70V (Ex)	<b>0336-543</b> ●																																								
	<p><b>20 Equipotential bonding cable</b></p> <p>Serves to create electrically conductive connection between explosion proof pump and container as earthing and equipotential bonding function.</p> <p>2 m long with fastening clip <b>0204-994</b> ●</p>																																									

● Suitable for transferring combustible and easy inflammable liquids (e.g. ethanol, petrol) or in explosive hazard area.

Specification	Order-No.	Product detail
<p><b>34 Hoist</b> for eccentric screw pumps, with infinitely adjustable load balancer for easy lifting and moving of the pump.</p> <p>Load bearing capacity: 18-22 kg Tackle: 2 m</p> <p>Load bearing capacity: 22-25 kg Tackle: 2 m</p> <p>Load bearing capacity: 25-30 kg Tackle: 2 m</p>	<p><b>0371-013</b></p> <p><b>0371-014</b></p> <p><b>0371-015</b></p>	
<p><b>Electronical flow meter, HDO series</b> For metering thin bodied up to highly viscous media – also under high pressures and temperatures. For assembly onto an eccentric screw pump B70V or into a pipeline. Explosion proof flow meter types with Atex approval. See separate leaflet.</p>		
<p><b>4 Hose clips</b> Stainless steel hose clips with threaded screw for fixing hoses of various nominal bore at the hose connection.</p> <p>Nominal diameter: DN 25 (1") DN 32 - 38 (1 1/4" - 1 1/2")</p>	<p><b>0301-401</b></p> <p><b>0302-402</b></p>	
<p><b>5 Hose connector</b> The use of conductive hoses is obligatory in explosion hazard areas. The ohmic resistance between the armatures must be less than 10<sup>6</sup> ohm. The hose connection must ensure a highly conductive transition between hose and pump tube.</p> <p><b>Brass</b> for hose DN 32 (1 1/4") inner thread G 1 1/2 (EN 12 115) for hose DN 38 (1 1/2") inner thread G 1 1/2 (EN 12 115) for hose DN 50 (2") inner thread G 2 (EN 12 115)</p> <p><b>Stainless steel (1.4571)</b> for hose DN 32 (1 1/4") inner thread G 1 1/2 (EN 12 115) for hose DN 38 (1 1/2") inner thread G 1 1/2 (EN 12 115) for hose DN 50 (2") inner thread G 2 (EN 12 115)</p>	<p><b>0302-090</b> ●</p> <p><b>0302-091</b> ●</p> <p><b>5000-100</b> ●</p> <p><b>0302-096</b> ●</p> <p><b>0302-092</b> ●</p> <p><b>5000-101</b> ●</p>	

● Suitable for transferring combustible and easy inflammable liquids (e.g. ethanol, petrol) or in explosive hazard area.

## Product detail

## Specification

## Order-No.

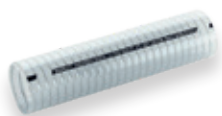

### 8 PVC spiral hose, fabric reinforced

Hose made of PVC, with woven layer and imbedded galvanized steel helix.  
For aggressive, non-flammable liquids.

Operating pressure:	max. 14 bar
Temperature of medium:	-5 up to +65 °C
Nominal diameter:	Weight:
DN 25 (1")	0.67 kg/m
DN 32 (1 1/4")	0.80 kg/m
DN 38 (1 1/2")	1.15 kg/m
DN 50 (2")	1.60 kg/m

**0374-467\***  
**0374-468\***  
**0374-469\***  
**0374-470\***

\*Hose for food liquids, inside and outside smooth, complies with EU-regulations 10/2011 and 1935/2004.



### 8 Mineral oil hose

Colour coding: "yellow".

Hose for mineral oil products of all kinds and super up to 50 % aromatics and methanol content.  
Inner rubber NBR (conductive) and outer rubber NBR (not conductive).

Electrically conductive: Type Ω-CL (<10<sup>6</sup> Ohm between the fittings) according to TRbF 50 appendix B (TRbF 131/2).

Operating pressure:	max. 10 bar
Temperature of medium:	-25 up to +65 °C
Nominal diameter:	Weight:
DN 25 (1")	0.5 kg/m

**0374-462 ●**

Hose for mineral oil products of all kinds and super up to 50 % aromatics and methanol content.  
Inner rubber NBR and outer rubber chloroprene (CR).

Electrically conductive: Type Ω/T (<10<sup>6</sup> Ohm between the fittings,  
<10<sup>9</sup> Ohm through the hose wall) according to DIN EN 12115:2011.

Operating pressure:	max. 16 bar
Temperature of medium:	-30 up to +90 °C
Nominal diameter:	Weight:
DN 32 (1 1/4")	1.0 kg/m
DN 38 (1 1/2")	1.2 kg/m

**0374-413 ●**  
**0374-414 ●**



### 8 Solvent hose

Colour coding: "blue".

Hose suitable for a wide range of commercial solvents.

Inner rubber of special coating and outer rubber of NBR/PVC-Compound  
(from DN 32 with galvanized steel helix it is suitable as suction and pressure hose).

Electrically conductive: Type Ω/T (<10<sup>6</sup> Ohm between the fittings,  
<10<sup>9</sup> Ohm through the hose wall) according to DIN EN 12115:2011.

Operating pressure:	max. 16 bar
Range of temperature:	-20 up to +80 °C (dependant on the liquid), steaming out up to 130 °C for max. 30 minutes (open ends)

Nominal diameter:	Weight:
DN 25 (1")	0.8 kg/m
DN 32 (1 1/4")	1.2 kg/m
DN 38 (1 1/2")	1.4 kg/m

**0374-417 ●**  
**0374-418 ●**  
**0374-450 ●**

● Suitable for transferring combustible and easy inflammable liquids (e.g. ethanol, petrol)  
or in explosive hazard area.

Specification	Order-No.	Product detail
<p><b>8 Universal chemical hose</b></p> <p>Colour coding: "blue/white/blue".                      Suitable for clean chemicals, cosmetics, photo-chemicals, paints and glues, washing and cleaning products, hygienic products as well as foodstuffs and luxury foodstuffs, (for more information see resistance table).                      Conform to FDA and USP class VI. Complies with EU-regulations 10/2011 and 1935/2004.                      Internal finish: UPE light with spiraled OHM conductive stripes UPE black, smooth, non-bleeding, abrasion-resistant. Intermediate layer: EPDM conductive (complies with the requirements of the recommendation XXI category 2 of the BfR and FDA standards).                      External finish: EPDM light grey, conductive, non-bleeding, ozone- and UV resistant, hardly inflammable, (starting from DN 25 with galvanized steel helix, suitable as suction and pressure hose).                      Electrically conductive: Type <math>\Omega/T</math> (<math>&lt;10^6</math> Ohm between the fittings, <math>&lt;10^9</math> Ohm through the hose wall) according to DIN EN 12115:2011.</p> <p>Operating pressure: max. 16 bar                      Range of temperature: -30 up to +100 °C (dependant on the liquid),                      steaming out up to 130°C for max. 30 minutes (open ends)</p> <p>Nominal diameter: Weight:                      DN 25 (1") 0.8 kg/m                      DN 32 (1 1/4") 0.9 kg/m                      DN 38 (1 1/2") 1.2 kg/m</p>	<p><b>0374-476</b> ●  <b>0374-477</b> ●  <b>0374-478</b> ●</p>	
<p><b>8 Special chemical hose FEP</b></p> <p>Colour coding: "blue/white/red".                      Suitable for all commonly used media, ideal also for very pure products. Suitable as suction and pressure hose.                      Internal finish: FEP transparent, smooth, seamless, non-leaching, non-dyeing, not electrically conductive (in conformity with FDA and USP Class VI demands).                      External finish: EPDM electrically conductive. Light grey with OHM conductive stripes, with galvanized steel helix.                      Electrically conductive Type <math>\Omega-C</math> (<math>&lt;10^6</math> Ohm between the fittings) according to DIN EN 12115:2011.                      (<b>NOT</b> suitable for non-conductive, flammable liquids)</p> <p>Operating pressure: max. 16 bar                      Range of temperature: -30 up to +100 °C (dependant on the liquid),                      steaming out for cleaning and sterilisation permissible up to 150°C                      for max. 30 minutes (open ends)</p> <p>Nominal diameter: Weight:                      DN 25 (1") 1.0 kg/m                      DN 32 (1 1/4") 1.1 kg/m                      DN 38 (1 1/2") 1.5 kg/m</p>	<p><b>0374-429</b>  <b>0374-430</b>  <b>0374-455</b></p>	
<p><b>Special chemical hose PTFE</b></p> <p>Colour coding: "blue/white/red".                      Suitable for all commonly used media, ideal also for very pure products. Suitable as suction and pressure hose.                      Internal finish: PTFE black, smooth, seamless, electrically conductive (conform to FDA and USP class VI. Complies with EU-regulations 10/2011 and 1935/2004).                      External finish: EPDM electrically conductive. Black, galvanized steel helix.                      Electrically conductive: Type <math>\Omega/T</math> (<math>&lt;10^6</math> Ohm between the fittings, <math>&lt;10^9</math> Ohm through the hose wall) according to DIN EN 12115:2011.</p> <p>Operating pressure: max. 16 bar                      Range of temperature: -30 up to +150 °C (dependant on the liquid),                      steaming out for cleaning and sterilisation permissible up to 150°C                      for max. 30 minutes (open ends)</p> <p>Nominal diameter: Weight:                      DN 25 (1") 1.0 kg/m</p>	<p><b>0374-482</b> ●</p>	
<p><b>23 Protection device for drum inliner</b></p> <p>For mounting onto the pump foot. Protects sensitive drum inliner and bags from damage.                      For pump tube B70V 120.1</p>	<p><b>0175-332</b></p>	

● Suitable for transferring combustible and easy inflammable liquids (e.g. ethanol, petrol) or in explosive hazard area.



# Accessories

## Contact-free indirect measurement



### Product detail

### Specification

### Order-No.

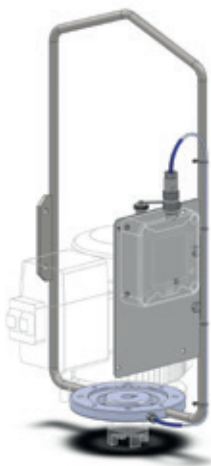

#### 1 Lifting device with integrated impulse sensor

Comprises of:

Impulse sensor with connecting cable and 14-wire coupling plug, lifting device and flange plate.  
(Please order suitable impulse transmitter and control unit additionally)

Additional price\* for three-phase motors up to 1.1 kW

**0172-891**

Additional price\* for three-phase motors up to 1.5 kW  
and explosion proof three-phase motors Ex

**0172-892** ●

Complete set for retrofitting available pumps

**0172-890** ●

\*(Please indicate Ref. No. for additional price when ordering a pump)

#### 2 Impulse transmitter

Must be ordered additionally suitable for the shaft diameter of the motor.

For shaft diameters:

Ø 19 mm

**0172-824**

Ø 20 mm

**0172-825**

Ø 24 mm

**0172-826**

Ø 25 mm

**0172-827**



Ø 28 mm

**0172-828**

Ø 30 mm

**0172-829**

● Suitable for transferring combustible and easy inflammable liquids (e.g. ethanol, petrol)  
or in explosive hazard area.

Specification	Order-No.	Product detail
<p><b>3 Control unit</b> with touch screen display and menu-navigated operation. Is intended for evaluation of impulses and display of flow volume, battery-operated**</p> <p>Control unit BE10 Control unit Ex BE10B</p> <p><b>Power supply unit NG10 230 V</b> for external power supply of the operating unit 220-240 V, 50-60 Hz, II (2) G [Ex ib Gb] IIC</p>	<p><b>0230-000</b> <b>0230-010</b> ●</p> <p><b>0230-230</b></p>	
<p><b>Accessories optional</b></p> <p><b>Relay module RM30</b> For three-phase motors up to 1.5 kW allows the filling with pre-selection (batch function), 400 V, 1.5 kW, 50 Hz, II (2) G [Ex ib Gb] IIC</p> <p><b>Power cable RM30 400V</b> 400 V, 50 Hz, 5-wire, 5 m long</p> <p><b>Connecting cable motor RM30 400V</b> 400 V, 50 Hz, 5-wire, 0.6 m long</p> <p><b>Relay module RM10</b> For three-phase motors with frequency converter allows the filling with pre-selection (batch function), 220-240 V, 50-60 Hz, II (2) G [Ex ib Gb] IIC</p> <p><b>Power cable RM10 230V</b> 230 V, 50 Hz, 5 m long</p> <p><b>Adapter cable motor RM-FU 230V/24V</b> For three-phase motors with frequency converter 230V AC/24V DC</p>	<p><b>0230-220</b></p> <p><b>0211-388</b></p> <p><b>0211-386</b></p> <p><b>0230-200</b></p> <p><b>0211-155</b></p> <p><b>0230-323</b></p>	

\*\* Limited battery operation without power supply unit possible